



**Jonathan Green**

QUALITY LAWNS SINCE 1881

REMEMBER TO  
"FEED YOUR SOIL"



THE NEW AMERICAN LAWN

**THE NEW AMERICAN LAWN**

# PRO ROTARY SPREADER

## Instruction Manual



[www.jonathangreen.com](http://www.jonathangreen.com)

Read the instructions and precautions before using this spreader.

Spreader holds up to 100 lbs. of most fertilizer products.

Do not discard - contains spreader settings.



0 79545 10939 4

# TABLE OF CONTENTS

Controls and Features Identification .....	3
Helpful Hints, Component & Hardware .....	4
Assembly Instructions .....	5, 6
Spreading Instructions.....	7
Jonathan Green Product Spreader Settings .....	8
Using Your Spreader .....	9
Maintenance and Storage.....	10
Specifications .....	10
General Warnings and Rules.....	11
Hazard Signal Word Definitions .....	12
Parts Drawing & Parts List.....	13, 14

## Controls and Features Identification

Read this owner's manual before operating the equipment. Familiarize yourself with the location and function of the controls and features. Save this manual for future reference.



- 1) Handle** – Pushes and moves the spreader easily.
- 2) Flow Control** – Controls the flow of material being spread.
- 3) Hopper** – Do not exceed rated load capacity 100 lbs.
- 4) Tires / Wheel** – Do not exceed recommended rated 25 PSI.
- 5) Impeller** - Evenly distributes material.
- 6) Support Leg** – Stabilizes load and spreader.

## Helpful Hints

### **ASSEMBLY IS REQUIRED - READ THE DIRECTIONS BEFORE ASSEMBLY**

- This product requires some assembly before use. See "Assembly" section for instructions. Because of the weight and size of the New American Lawn Pro Rotary spreader, it is recommended that another adult be present to assist with the assembly. **INSPECT ALL COMPONENTS** closely upon receipt to make sure no components are missing or damaged.

### **! CAUTION**

Read and follow all instructions for assembly and operation. Failure to properly assemble this equipment could result in serious injury to the user or bystanders, or cause equipment damage.

### **Remove and identify loose parts from carton and bag.**

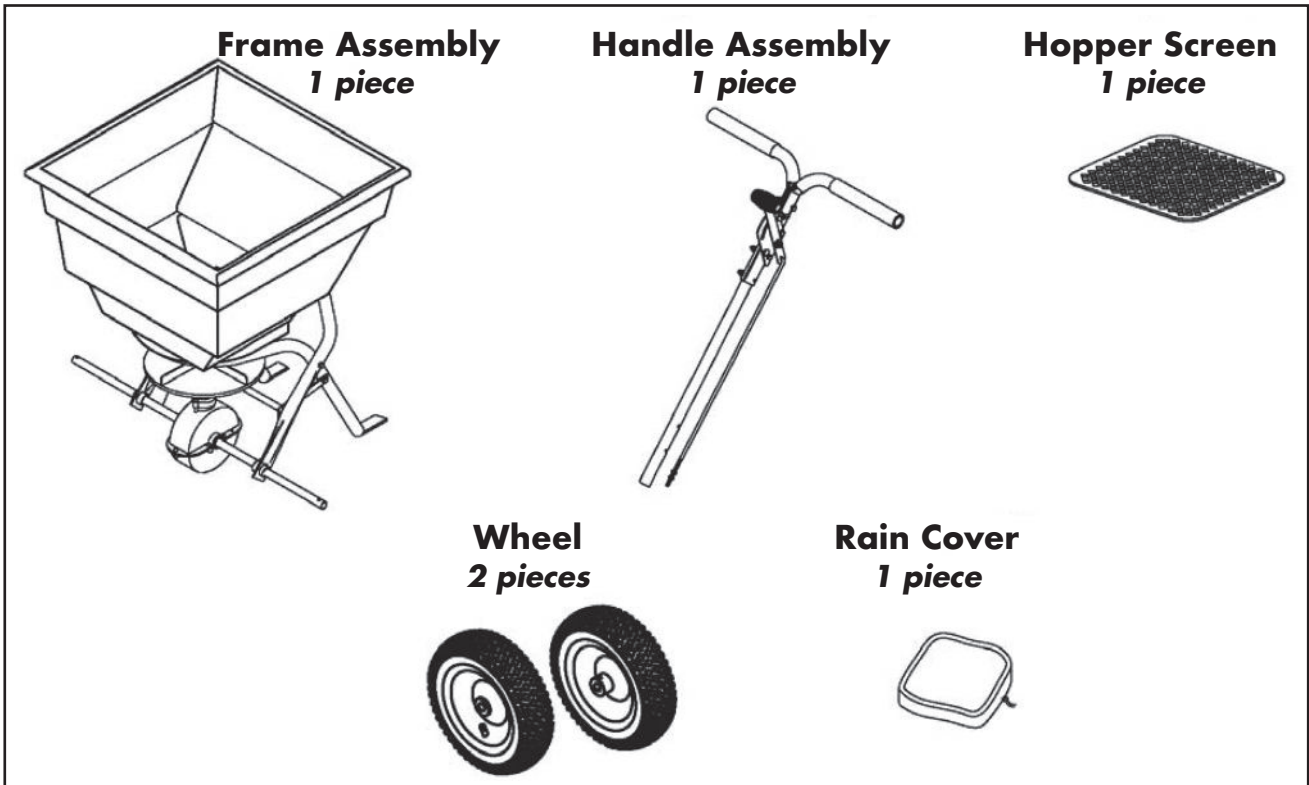

**Lock Nut M5**  
1 piece



**Hex Bolt M5 x 45**  
1 piece



**Axle End Cover**  
2 pieces



**Flat Washer Ø 16**  
1 piece

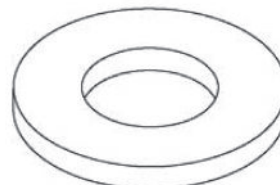

## Assembly Instructions

**STEP 1:** Install right Tire Assembly to right Axle using bolt M5x45 and lock nut M5, and then install the axle end cover onto right Axle using a wooden or rubber hammer. Now install left Tire Assembly to left Axle, put a flat washer  $\varnothing 16$  and install the axle end cover onto left Axle using a wooden or rubber hammer.

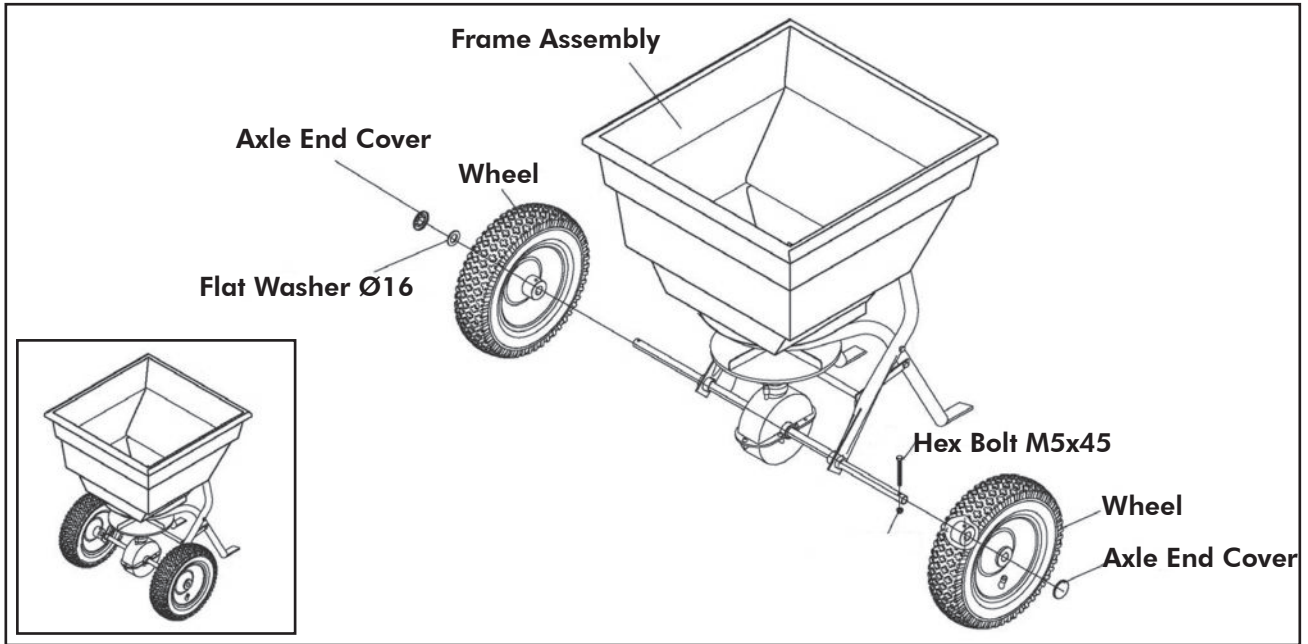

**STEP 2:** (1) Attach the pivot & bracket assembly into middle connecting handle by using hex bolt M6x55 and hex lock nut M6. (2) Take off one of the nuts and insert the threaded pole into this hole. Then put on the nut again.

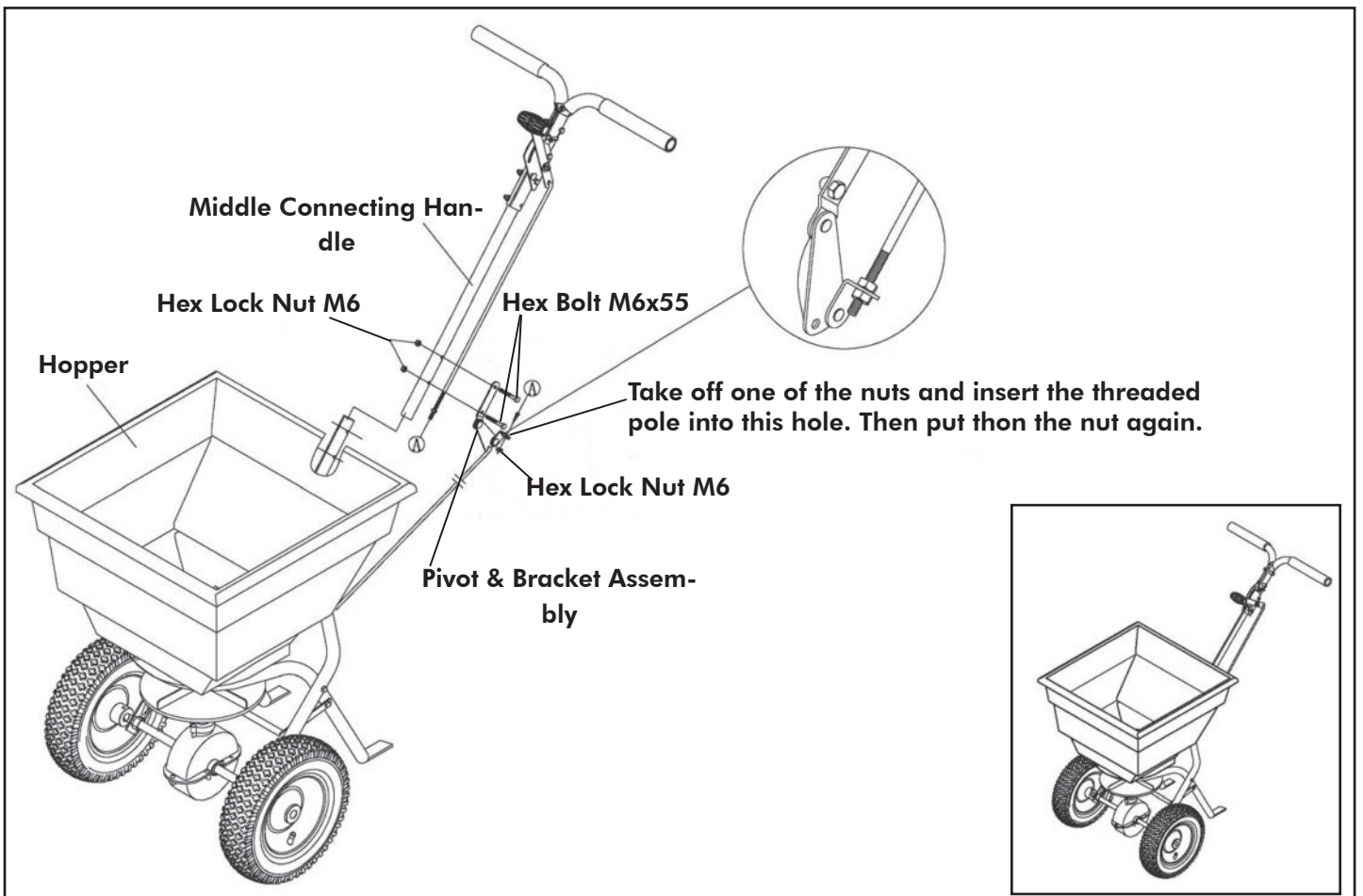

**STEP 3: ADJUSTABLE.** When you finished all above steps, if you find the three big holes at the bottom of hopper just match the three holes of adjustable plate. You don't need to do the following steps. If they are not match neatly, you may need to do the following steps. (1) Push the handle to the lowest position <downwards>. (2) Adjust the positions of these two nuts on threaded control bar so as to make sure the three big holes at the bottom of hopper match close to the three holes of adjustable plate (must closed properly).

To operate this spreader, push the handle to the top position (upwards). You may move the position of the Wing nut on Gauge & Lever to adjust the spacer of three holes between hopper and adjustable plate as per your need when spreading.

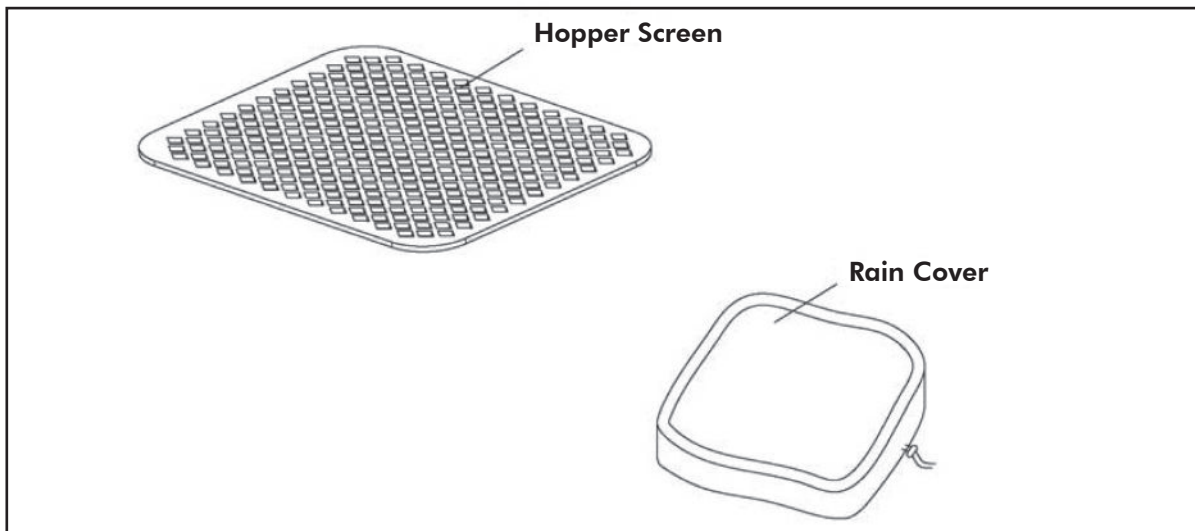
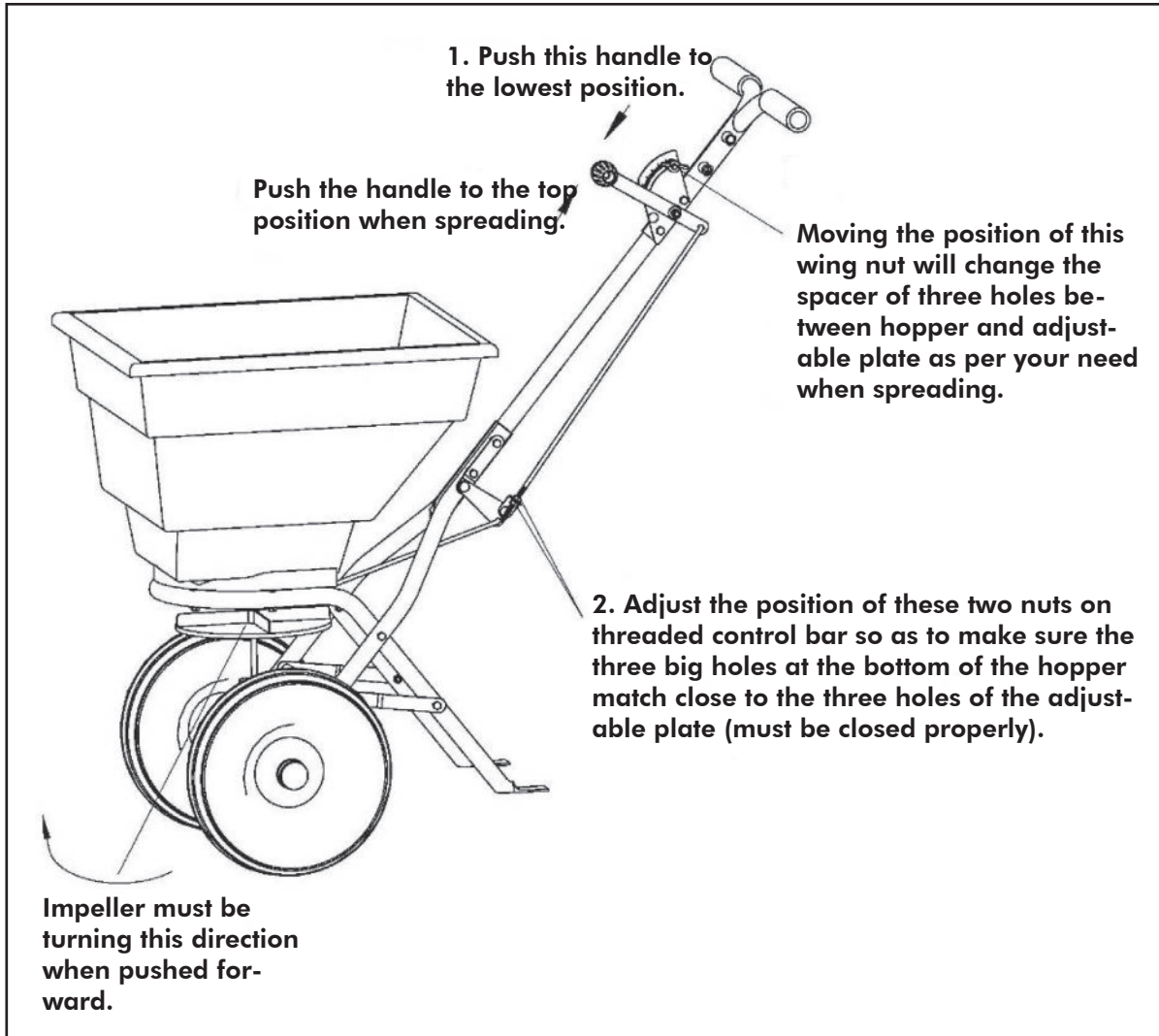



# Spreading Instructions

## CALCULATING AMOUNT OF MATERIAL NEEDED

To calculate the amount of fertilizer you will need to cover your lawn, divide the coverage amount listed on the label by the weight of the fertilizer bag. For example a 10 lb. bag of fertilizer with coverage of 10,000 square feet will distribute 1 lb. of fertilizer every 1,000 square feet at full rate or 1/2 lb. of fertilizer every 1,000 square feet at half rate. For pre-calculated rates see **Chart A** (Example: 25 lb. bag with 15,000 sq. ft. coverage = 1.7 lb./1,000 sq. ft.). Use **Chart B** to find the closest spreader setting for Fertilizer (Example: 1.7 lb./1000 sq. ft. = Spreader Setting of 5). Use **Chart C** to find the closest spreader setting for Grass Seed.

**Chart A - Square Foot Coverage per Bag\***

Weight of Bag (LBS.)	LBS. per 1,000 SQ. FT.		
	5,000 SQ. FT. COVERAGE	10,000 SQ. FT. COVERAGE	15,000 SQ. FT. COVERAGE
5	1.0 LB.	0.5 LB.	0.3 LB.
10	2.0 LB.	1.0 LB.	0.7 LB.
15	3.0 LB.	1.5 LB.	1.0 LB.
18	3.6 LB.	1.8 LB.	1.2 LB.
20	4.0 LB.	2.0 LB.	1.3 LB.
25	5.0 LB.	2.5 LB.	1.7 LB.
30	6.0 LB.	3.0 LB.	2.0 LB.
35	7.0 LB.	3.5 LB.	2.3 LB.
40	8.0 LB.	4.0 LB.	2.7 LB.
45	9.0 LB.	4.5 LB.	3.0 LB.
50	10.0 LB.	5.0 LB.	3.3 LB.

\*These are only estimates actual amounts may vary.

## THESE ARE APPROXIMATE SETTINGS AND ARE INTENDED AS A GUIDE ONLY.

**Chart B - FERTILIZER Spreader Settings/Spread Widths**

LBS. PER 1,000 SQ. FT.	SPREADER SETTING	● SMALL PARTICLE SPREAD	● MEDIUM PARTICLE SPREAD	● LARGE PARTICLE SPREAD
1	3	5-6 FT.	6-9 FT.	9-12 FT.
2	5	5-6 FT.	6-9 FT.	9-12 FT.
3	7	5-6 FT.	6-9 FT.	9-12 FT.
4	10	5-6 FT.	6-9 FT.	9-12 FT.
5	12	5-6 FT.	6-9 FT.	9-12 FT.
6	15	5-6 FT.	6-9 FT.	9-12 FT.
7	17	5-6 FT.	6-9 FT.	9-12 FT.
8	20	5-6 FT.	6-9 FT.	9-12 FT.
9	22	5-6 FT.	6-9 FT.	9-12 FT.
10	25	5-6 FT.	6-9 FT.	9-12 FT.

**Chart C - GRASS SEED  
Spreader Settings**

LBS. PER 1,000 SQ. FT.	SPREADER SETTING
1	12
2	13
3	14
4	15
5	16
6	17
7	18
8	19
9	20
10	21

**NOTE: DO NOT SPREAD SALT.** Spreading salt in this spreader may damage the mechanism and shorten the life of the machine.

# Jonathan Green Product Spreader Settings

## ! CAUTION

These are approximate settings and are intended as a guide only. Variations in materials, walking speed, terrain, weather conditions, age and condition of spreader, etc. can affect setting. If unsure, start at a lower setting and increase if necessary. Always calibrate your spreader before using.

GRASS SEEDS	OVERSEEDING	NEW LAWNS	ORGANICS
Black Beauty Original	14	Apply a second	Organic Lawn Food 15
Black Beauty Ultra	13		Corn Gluten Weed Preventer 17
Blue Panther	9	time to the same area	Organic Insect Control 13-14
Dense Shade	14		
Fall Magic	14	using the rates listed	<b>LAWN FOODS</b>
Fast Grow	13		Green-Up with Crabgrass Preventer 14
Heavy Traffic	13	on left.	Green-Up Weed & Feed 11
Shady Nooks	14		Summer Survival Lawn Food 14
Solargreen	13	←	Winter Survival Fall Lawn Food 12
Sun & Shade	12		Crabgrass Preventer plus New Seeding 12
Sunny	12		Green-Up Lawn Food 14
Touch-Up	14		Green-Up Lawn Food for Seeding and Sodding 12-13
			Winter Survival Weed & Feed 10-11
<b>SOIL FOODS</b>			<b>LAWN CONTROLS</b>
Love Your Soil		11-12	Season-Long Weed Preventer 9
MAG-I-CAL - Acidic (silver)		11-12	Grub & Insect Control 12
MAG-I-CAL Plus - Acidic (black)		11-12	Lawn Fungus Control 11
MAG-I-CAL Plus - Alkaline (purple)		11-12	Lawn Moss Control 10
			Lawn Weed Control 13

**Go to page 9 for setting illustration.**

**Review product package for other details or spreader rates.**

**Settings for other brands are on package or go to [www.jonathangreen.com](http://www.jonathangreen.com)**

### USAGE TIPS

#### For rectangular lawns

Apply two header strips across each end for a turning area. Then apply back and forth in the longest direction.

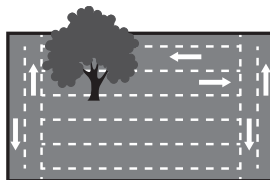

#### For irregular-shaped lawns

Apply a header strip around the entire lawn for a turning area, then apply back and forth.

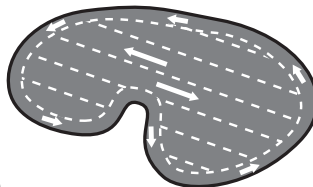

#### Note:

Each pass should be within 5 feet of each other to ensure an overlap.

- Do not leave spreader open when making turns.
- For best results, do not apply on a windy day.
- Swath will vary due to conditions. (see above caution)
- To determine how much coverage you need, multiply the length of your lawn by its width. This equals your total square footage. Deduct any non-lawn areas (house, gardens, walkways, etc.).

\_\_\_\_\_ Length (Feet)  
**X** \_\_\_\_\_ Width (Feet)  
 = \_\_\_\_\_ Total Square Feet  
 - \_\_\_\_\_ Non-Lawn Areas (Feet)  
 = \_\_\_\_\_ Total Square Feet coverage you need

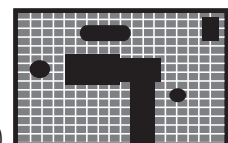

Keep lawn products out of reach of children. Do not apply near water, storm drains, or drainage ditches. Do not apply if heavy rain is expected. Apply only to your lawn or garden and sweep any product that lands on the driveway, sidewalk or street back onto your lawn or garden. Also, sweep product off concrete surfaces to avoid staining.



## Using Your Spreader

1. Determine approximate square footage of area to be covered and estimate amount of material required.
2. Before filling the hopper, make sure the flow control arm is in the off position and the closure plate is shut.
3. Break up any lumpy fertilizer as you fill the hopper.
4. Set the adjustable stop with the flow control arm still in the off position. Refer to the application chart on this page and to the instructions on the fertilizer bag to select the proper flow rate setting.
5. The application chart is calculated for light to heavy application at a vehicle speed of 3 mph, or 100 ft. in 23 seconds. A variation in speed will require an adjustment of the flow rate to maintain the same coverage. The faster you drive, the wider the broadcast width.
6. Make sure the drive pin is installed in the axle before starting the spreader.
7. Always start the spreader in motion before opening closure plate.
8. Always shut the closure plate before turning or stopping the spreader.
9. If fertilizer is accidentally deposited too heavily in a small area, soak the area thoroughly with a garden hose or sprinkler to prevent burning of the lawn.
10. To insure uniform coverage, make each pass so that the broadcast pattern slightly overlaps the pattern from the previous pass as shown in figure below. The approximate broadcast widths for different materials are shown in the application chart on this page.
11. When broadcasting weed control fertilizers, make sure the broadcast pattern does not hit evergreen trees, flowers or shrubs.

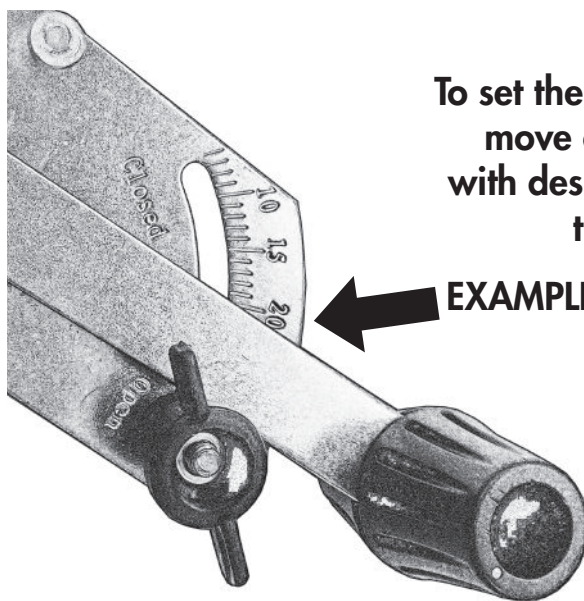

To set the proper spreader setting, move on-off handle to align with desired setting number and tighten wing nut.

**EXAMPLE:** This is a setting of 20.

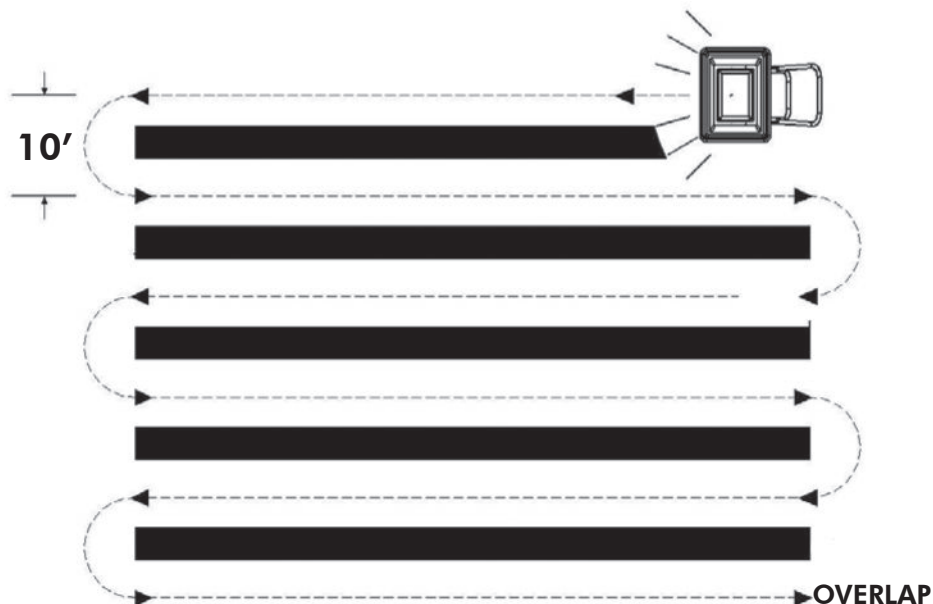

## Maintenance and Storage

### **WARNING**

Improper maintenance and storage of this spreader may void your warranty.

### **Maintenance**

- After each use clean material out of hopper.
- Rinse/dry inside and outside of the spreader after each use.
- Before operating make sure the tires have the RECOMMENDED TIRE PRESSURE 25 PSI.
- Periodically check all fasteners for tightness.
- Annually clean and lightly lubricate parts.
- Use a glossy enamel spray paint to touch up scratched or worn painted metal surfaces.
- Never exceed fertilizer load capacity rating of 100 lbs., it will damage the spreader.

### **IMPORTANT**

The warnings, cautions, and instructions outlined in this instruction manual cannot cover all possible conditions or situations that may occur. It must be understood by the operator that common sense and caution are factors which cannot be built into this product and must be supplied by the operator.

### **Storage**

- Never allow material to remain in the hopper for extended periods of time.
- Before storing make sure the spreader is clean and dry for years of trouble free service.
- Store indoors or protected area during severe weather and winter months.

## **Specifications**

Load Capacity .....	100 lb.
Spreader Type .....	Broadcast
Hopper Material .....	Polypropylene
Hopper Dimensions .....	21.5" x 21.5"x14"
Overall Dimensions .....	48.8"x32.1"x21.7"
Wheel size .....	12.5"
Tire Pressure (PSI) .....	25

The manufacturer reserves the right to make improvements in design and/or changes in specifications at any time without incurring any obligation to install them on units previously sold.

## **⚠️GENERAL WARNINGS⚠️**

### **READ and UNDERSTAND this manual completely before using The New American Lawn Pro Rotary Spreader.**

Operator must read and understand all safety and warning information, operating instructions, maintenance and storage instructions before operating this equipment. Failure to properly operate and maintain the New American Lawn Pro Rotary spreader could result in serious injury to the operator or bystanders.

#### **Operation Warnings**

- Do not at any time carry passengers sit or stand on the spreader.
- Do not allow children to play on, stand upon or climb in the spreader.
- Always inspect the spreader before using to assure it is in good working condition.
- Replace or repair damaged or worn parts immediately.
- Always check and tighten hardware and assembled parts before operation.
- Do not exceed equipment maximum fertilizer load capacity of 100 lbs.
- Avoid large holes and ditches when transporting loads.
- Be careful when operating on steep grades (hill) the spreader may tip over.
- Do not push close to creeks, ditches and public highways.
- Do not use spreader on windy days when spreading grass seed or herbicides.
- Always use caution when loading and unloading spreader.
- Never tow the spreader with a motorized vehicle.

#### **Crush and Cut Hazards**

- Always keep hands and feet clear from moving parts while operating the equipment.
- Always clear and keep work area clean when operating.
- Always wear safety gear, eye protection, gloves and work boots when operating the spreader.





#### **⚠️WARNING**

The warnings, cautions, and instructions outlined in this instruction manual cannot cover all possible conditions or situations that may occur. It must be understood by the operator that common sense and caution are factors which cannot be built into this product and must be supplied by the operator.

#### **⚠️WARNING**

This product can expose you to chemicals including lead and lead compounds which are known to the State of California to cause cancer and birth defects or other reproductive harm. For more information, go to [www.P65Warnings.ca.gov](http://www.P65Warnings.ca.gov)

## Hazard Signal Word Definitions

	This is the safety alert symbol. It is used to alert you to potential personal injury hazards. Obey all safety messages that follow this symbol to avoid possible injury or death.
	DANGER indicates an imminently hazardous situation which, if not avoided, will result in death or serious injury.
	WARNING indicates a potentially hazardous situation which, if not avoided, could result in death or serious injury.
	CAUTION indicates a potentially hazardous situation which, if not avoided, may result in minor or moderate injury.
	CAUTION used without the safety alert symbol indicates a potentially hazardous situation which, if not avoided, may result in property damage.

### ABOUT YOUR NEW AMERICAN LAWN PRO ROTARY SPREADER

This New American Lawn Pro Rotary spreader is designed to spreader a wide range of materials (Fertilizer and Grass Seed). Never exceed the rated fertilizer load capacity of 100 lbs. when operating the spreader.

Your spreader needs to be pushed at three miles per hour, which is a brisk walking speed. Slower or faster speeds will change the spread patterns. Wet spreading material will also change the spread pattern and flow rate. Clean your spreader thoroughly after each use. Wash between the shut off plate and bottom of the hopper.

Ensure that the FRONT of the gear box points to the front of the spreader. The impeller must turn clockwise. Reversing the gear box will cause the impeller to turn counter clockwise. Clean the impeller plate after each use. Spreading material stuck on the impeller blades will cause uneven spreading.

**Do not open the gear box or dirt may enter the gears, which are permanently lubricated at the factory.**

Technical specifications on the New American Lawn Pro Rotary spreader are provided in the "Specifications" section of this manual.

## Parts Drawing

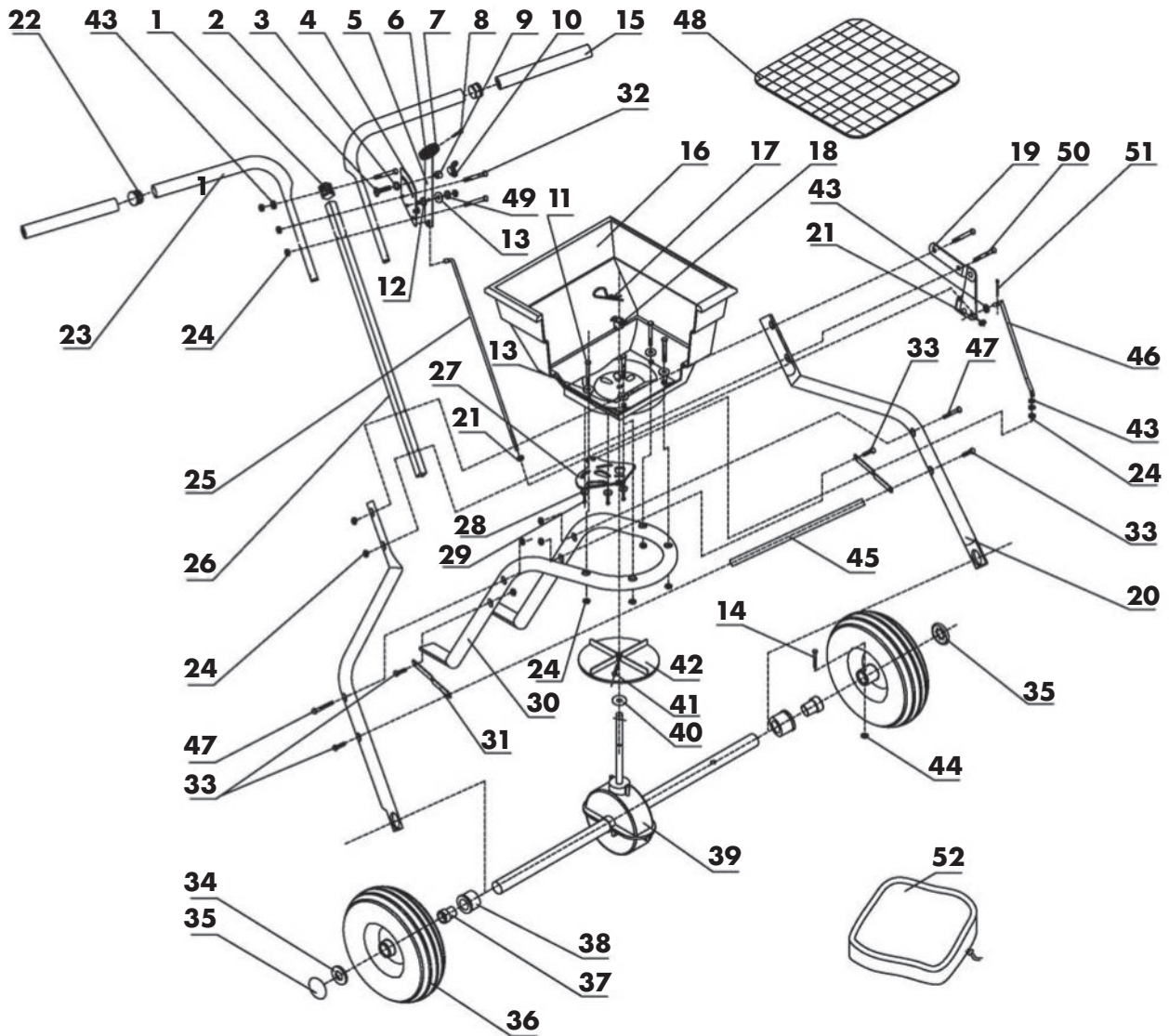

## Parts List

REF#	DRAWING NO.	DESCRIPTION	QTY
1	N572-00003	Handle Spacer	1
2	9114-06025-DG	Carriage Bolt M6x25	1
3	9315-08000-DG	Teeth Lock Washer Ø8	1
4	N570-10000	Gauge & Lever Assembly	1
5	N570-00001-DG	Adjustable Handle Pole	1
6	N570-00014	Adjustable Handle A	1
7	N570-00015	Adjustable Handle B	1
8	9118-04018-DG	Screw M4x18	1
9	N510-00016	Spacer	1
10	N510-00019	Wing Nut M6	1
11	9101-06045-DG	Hex Bolt M6x45	4
12	C130-00004	Nylon Washer	1
13	9302-06000-DG	Big Flat Washer Ø6	5
14	9101-05045-DG	Hex Bolt M5x45	1

<b>REF#</b>	<b>DRAWING NO.</b>	<b>DESCRIPTION</b>	<b>QTY</b>
15	N570-00009	Handle Cover	2
16	N572-00001	Hopper	1
17	N570-00017-DG	R Pin Ø2	1
18	N510-00004	Hopper Bushing	1
19	N572-10000	Pivot & Bracket Assembly	1
20	N570-00007	Wheel Assembly Frame	2
21	9201-06000-DG	Hex Nut M6	2
22	T680-00003	End Cover	2
23	N570-00006	Upper Handle	2
24	9206-06000-DG	Lock Nut M6	15
25	N570-00003-DG	Control Rod A	1
26	N572-00002	Middle Connecting Handle	1
27	N570-00023	Shut off plate	1
28	9302-04000-DG	Big Flat Washer Ø4	3
29	9118-04012-DG	Screw M4x12	3
30	N572-00005	Hopper Assembly Frame	1
31	N570-00010-DG	Frame Brace	2
32	9101-06050-DG	Hex Bolt M6X50	3
33	9101-06035-DG	Hex Bolt M6X35	4
34	9301-16000-DG	Flat Washer Ø16	1
35	N511-40000-BXG	End Cap	2
36	N570-00020	Tire	2
37	N570-00018	Inner Axle Bushing	2
38	N570-00011	Outer Axle Bearing	2
39	N570-40000	Gear Box & Axle Assembly	1
40	N570-00002	Thin Washer	1
41	9110-04020-DG	Screw M4x20	1
42	N510-00003	Impeller	1
43	9301-06000-DG	Flat Washer Ø6	4
44	9206-05000-DG	Lock Nut M5	1
45	N570-00021-DG	Connecting Cross Bar	1
46	N570-00004-DG	Adjustable Connecting Rod B	1
47	9101-06060-DG	Hex Bolt M6x60	2
48	N572-00004	Hopper Screen	1
49	9306-06000-DG	Lock Washer Ø6	1
50	9101-06055-DG	Hex Bolt M6x55	2
51	9404-02010-DG	Cotter Pin	1
52	N574-00002	Rain Cover	1